



In observance of Memorial Day, there will be no construction activity on Monday, May 25.

**NEW DATE! SATURDAY JUNE 6 AT 10:00 P.M. THROUGH JUNE 7 AT 10:00 A.M.**  
I-10 will be closed between Euclid Avenue and 4th Street for the demolition of the Sultana Avenue Bridge.

Please use caution when traveling through the corridor and allow extra time to reach your destination as you may experience delays.

**Detours:**

- **EB I-10:** Exit Euclid Avenue go south to Holt Boulevard, turn left onto Grove Avenue, right onto 4th Street to I-10
- **WB I-10:** Exit 4th Street, turn left onto 4th Street, turn left onto Grove Avenue, turn right at Holt Boulevard, right on Euclid Avenue to I-10

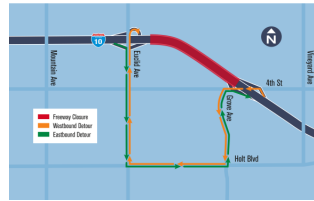

**In May:**

- Throughout the corridor, crews continue with tree removal, installation of construction signage, and removing sound walls and retaining walls. Work will occur on the freeway and on local streets.
- **Sultana Avenue Bridge:** To accommodate the widening of the I-10 freeway, Sultana Avenue over the freeway is closed to all vehicular and pedestrian traffic. The bridge will be demolished and reconstructed. Sultana Avenue will reopen in approximately 8 months. For more information click [here](#).
- **Euclid Avenue Bridge:** To accommodate the widening of the I-10 freeway, the Euclid Avenue bridge will be demolished and reconstructed in phases. During construction, the median will be removed and three lanes in each direction will be open to through traffic. This work began in mid-May and lasts for approximately 18 months. For more information click [here](#).
- **4th Street Utility Relocation:** To prepare for the widening of the I-10 freeway, crews will relocate underground utilities at 4th Street. This work began in mid-May and will last until summer 2020. For more information click [here](#).

## CONSTRUCTION ACTIVITIES

### Week of May 25

Be prepared! Speeds are reduced to 55-mph and lanes have shifted throughout the corridor. Slow down for your safety and our crews!

During construction, you may see flashing strobe lights on trucks, bright lights from light towers, and sparks from saws, and hear drilling, hammering, and equipment engines. Police may be onsite to assist with lane and ramp closures.

Please remember all construction is dynamic and the schedule is weather-permitting and subject to change. For the most up-to-date information, please check the google map linked below.

I-10		
Time	Location	Closures
6:00 a.m. to 5:00 p.m. and 9:00 p.m. to 6:00 a.m.	Elivanda Avenue to Indian Hill Boulevard WB and EB lanes and shoulders	Intermittent lane and shoulder closures; at least one lane in each direction will remain open
9:00 p.m. to 6:00 a.m.	WB I-10 to NB and SB I-15 interchange shoulders and lanes	Intermittent shoulder and lane closures; interchange will remain open
9:00 p.m. to 6:00 a.m.	WB and EB on- and off-ramps between Mountain Avenue and 4th Street	Intermittent on- and off-ramp closures; detour routes will be posted
9:00 p.m. to 6:00 a.m.	Euclid Avenue EB and WB on- and off-ramps	Ramps will be intermittently closed; detour routes will be posted
9:00 p.m. to 6:00 a.m.	Monte Vista Avenue and 4 <sup>th</sup> Street EB and WB off-ramps	Ramps will remain open for right turns only on to Monte Vista Avenue and 4th Street; detour routes will be posted
9:00 p.m. to 6:00 a.m.	Haven Avenue EB on-ramp shoulder	Shoulder closure; ramp will remain open

Local Streets		
Time	Location	Closures
9:00 p.m. to 6:00 a.m.	Monte Vista Avenue and 4 <sup>th</sup> Street	Streets under I-10 will be closed to through traffic; detour routes will be posted
6:00 a.m. to 5:00 p.m.	6 <sup>th</sup> Street	Intermittent lane and shoulder closures; street will remain open to through traffic
6:00 a.m. to 5:00 p.m. and 9:00 p.m. to 6:00 a.m.	Euclid Avenue	Lane closures; at least one lane in each direction will remain open to through traffic

Sign up for text messages by texting *#I10expresslanes* to 31996 (Reply STOP to cancel, text HELP for help. Normal text and data message rates may apply.)

Si prefiere recibir información de construcción en español, llame al (877) 55 - SBCTA.

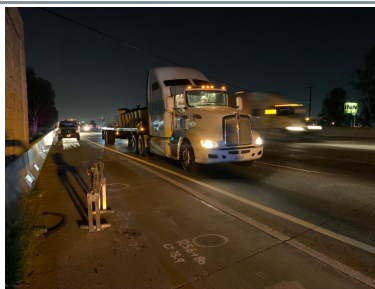

Water barriers and k-rail delivered onto the I-10 freeway.

**Other Construction Projects:**

- The City of Montclair is rehabilitating Central Avenue. More information about this project can be found [here](#).
- In the cities of Upland and Montclair, Metrolink will be performing railroad crossing maintenance on Central Avenue between Arrow Highway and Richton Street. More information can be found [here](#).

**PROJECT INFO**

Phase 1 of I-10 Express Lanes is located in the southwestern portion of San Bernardino County east of Los Angeles County. The project will provide choices on the I-10 freeway between the Los Angeles/San Bernardino line and I-15. The project includes two express lanes in each direction to offer trip reliability and ease congestion. In addition, lanes to assist drivers getting on and off the freeway (auxiliary lanes) will be constructed in selected locations. West of Haven Avenue, a single new lane will be constructed and combined with the existing HOV lane to provide two express lanes in each direction. The HOV lane will still be available to motorist, but increase from 2+ to 3+. East of Haven Avenue, two express lanes will be constructed. #gobcta #sbexpresslanes #beprepared #planbuildmove

To receive more information about the project and future construction, please [sign up here](#).

## CLOSURES & DETOURS

To view construction, closures and detours, click the Google icon below. This map includes all project work in real time.



CLICK TO SEE CLOSURES ON A GOOGLE MAP

Plan. Build. Move.

Per the Governor's Executive Order, the transportation and construction sectors are identified as critical. We will continue to progress on our efforts to deliver transportation projects throughout the county. Crews and office support staff are mindful of the need to reduce exposure whenever possible. Field work will incorporate safe practices relative to their operations and office personnel have been given latitude for working remotely as needed. We continue to watch for direction from the State and Federal levels and will assess our activities accordingly. We encourage you to understand road conditions before venturing out in project areas throughout the county.