

6" CONCRETE BLOCK WALL DETAILS

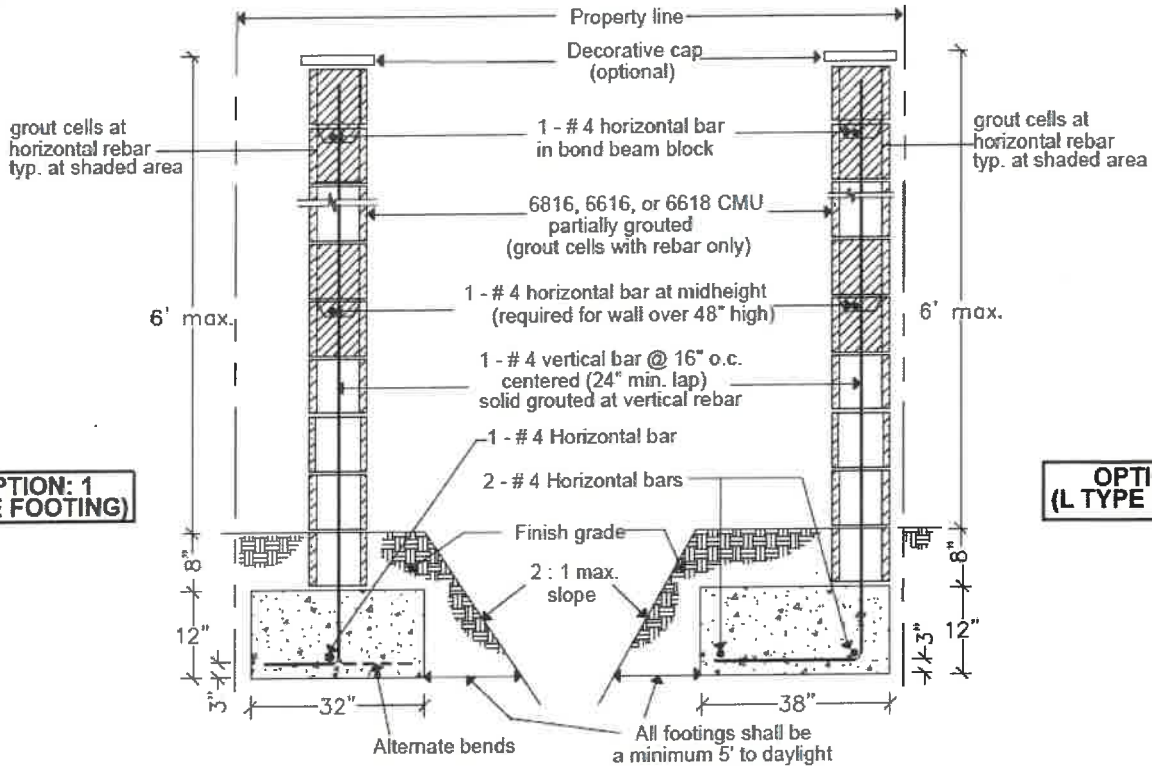

**OPTION: 1
(T TYPE FOOTING)**

**OPTION: 2
(L TYPE FOOTING)**

PILASTER

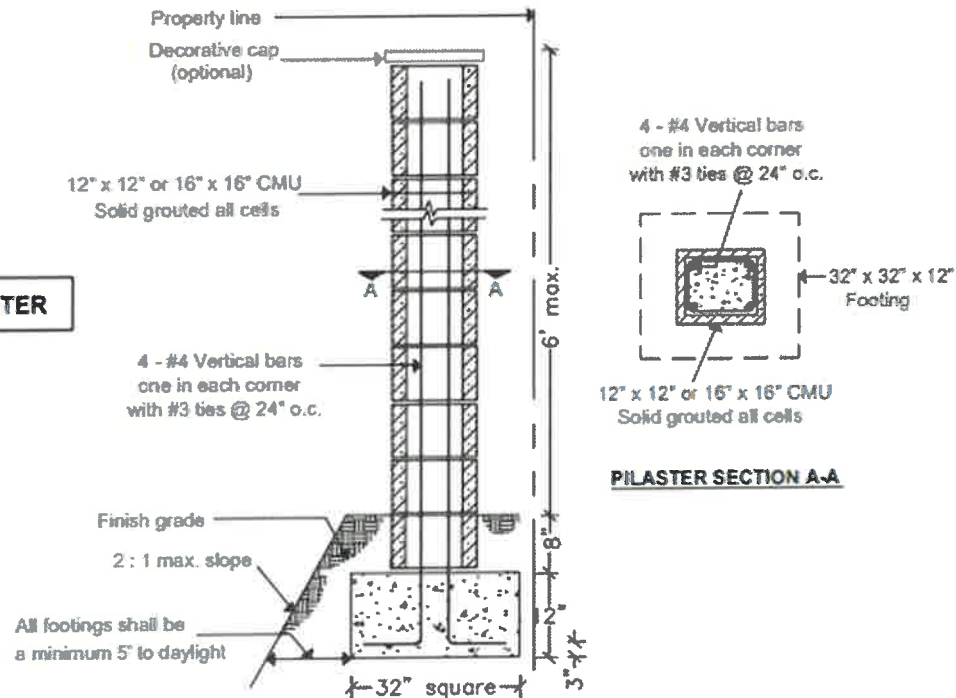

Approved by:  (James Caro, BO),

date: 3-1-23



**CITY OF ONTARIO
BUILDING DEPARTMENT**

303 East B Street
Ontario, CA 91764
Phone (909)395-2023, Fax (909)395-2180

**INFORMATION
BULLETIN**

202

Effective: 1 / 1 / 2023
Revised: ----

DESIGN CRITERIA:

1. Applicable codes per 2022 CBC and ASCE 7-16.
2. Wind speed 110 mph exposure C (per City Ordinance).
3. Seismic Design Category D.
4. Allowable soil bearing pressure 1,500 psf, passive soil bearing 100 psf/ft.

MATERIAL SPECIFICATIONS:

1. CONCRETE BLOCKS	Minimum compressive strength $f'_m = 2,000$ psi, normal weight units, grade N conforming to ASTM C90.
2. GROUT	2,000 psi min. strength or optional mix of 1 part cement, 3 part sand, and 2 parts pea gravel of 3/8" max. size.
3. MORTAR	1,800 psi min. strength type S or optional mix of 1 part cement, 3 parts sand, and 1/2 part lime.
4. CONCRETE FOR FOOTING	2,500 psi min. strength or optional mix of 1 part cement, 2 1/2 parts sand, 3 1/2 parts gravel of 3/4" max. size, and 7 gallons of water per 90 lb sack of cement.
5. STEEL REINFORCING BARS	Must be deformed bar, free from loose rust, and conforming to ASTM A615 grade 40 or 60.

REQUIRED INSPECTIONS:

1. **Footing inspection** (footing trenches with steel in place prior to placing the concrete)
2. **Reinforcing steel inspection** (steel in wall prior to grouting. Mid-height steel and grouting inspection is required when 6" slump stone block is used)
3. **Final inspection** (wall completed and site clean)

GENERAL NOTES:

- **Shared Common Walls:** if any portion of the wall crosses a property line, written permission from the adjacent property owner is required prior to permit issuance. Party Wall Letter form is available at City of Ontario Building Department web site.
- Finish grade shall be of equal elevation on each side of the wall. Maximum of 6" offset is permitted in the grade level with no surcharge loads.
- Concrete block wall over 3'-0" in height measured from adjacent grade shall require a building permit.
- Blocks shall be installed in running bond pattern such that the head joints in successive courses are horizontally offset at least 1/4 unit length.
- Provide clean outs for all lifts greater than 4 ft.
- Expansion joint spacing shall not exceed 30 ft length

DISCLAIMER:

Alternate wall designs may be possible when provided with an engineered analysis. Use of this standard design is at the user's risk and carries no implied or inferred guarantee against failure or defects.

SITE ADDRESS: _____

DATE: _____

OWNER'S NAME: _____

INSTRUCTIONS:

- 1) SHOW LOCATION OF WALLS & PILASTERS RELATIVE TO THE PROPERTY LINE ON THE SITE PLAN BELOW.
- 2) INDICATE THE LENGTH AND HEIGHT OF EACH WALLS & PILASTERS.

SITE PLAN

